

KINEX

High Precision Large Size Reducer

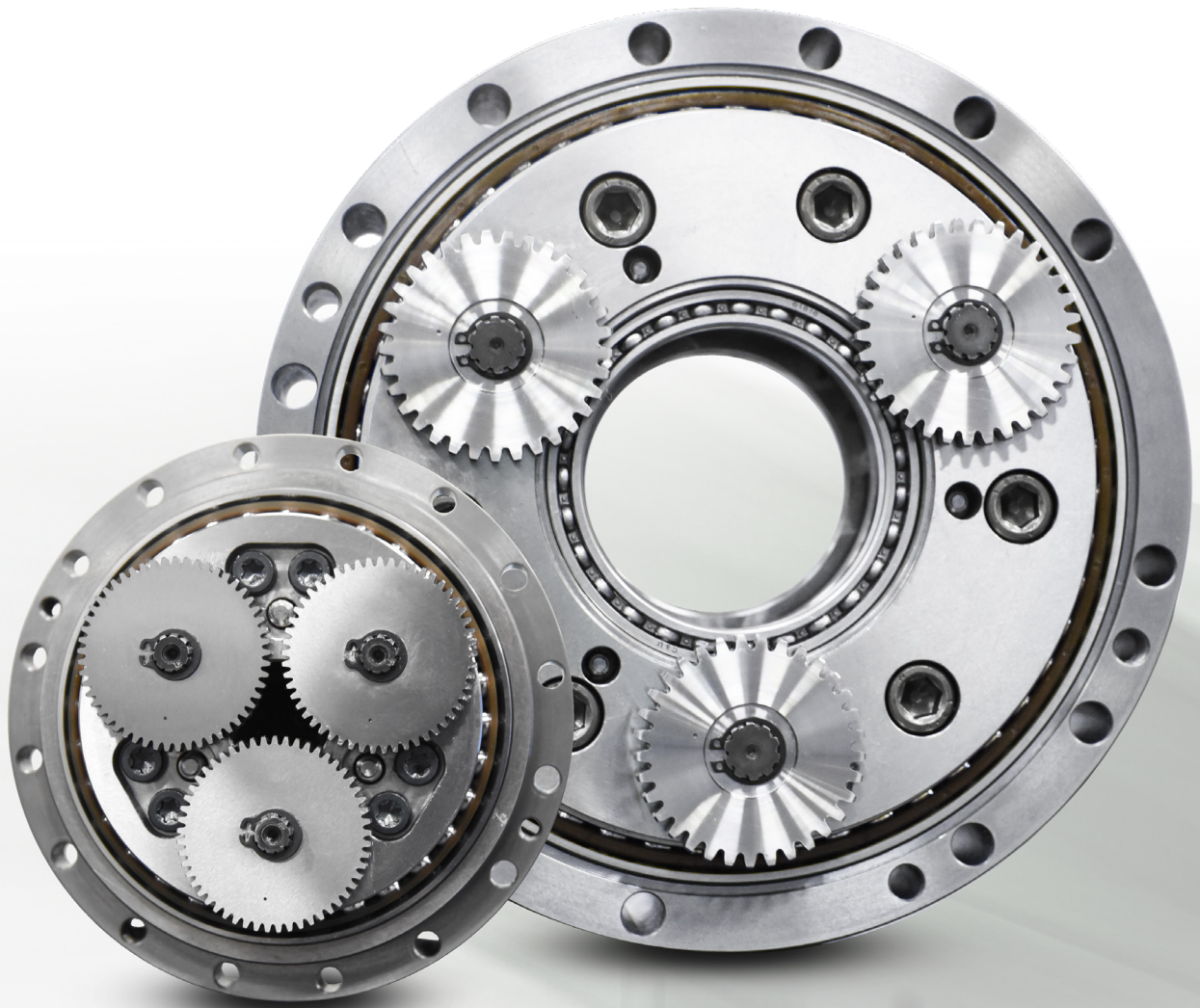

Professional Choice

Professional choice for precision reducers

KINEX

Product Lineup

Nseries

Solid shaft type: Lightweight and compact



Cseries

Hollow shaft type: Cable or hose can be passed through

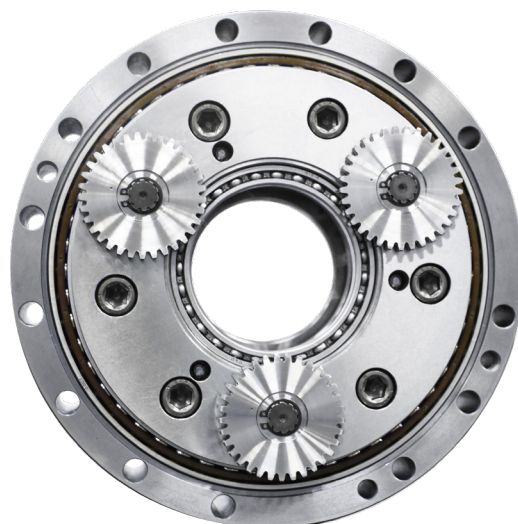

Smooth and quiet high precision large size reducer utilizing Nidec's technology.

Provides "excellent movement" for various applications, such as robots and machine tools.

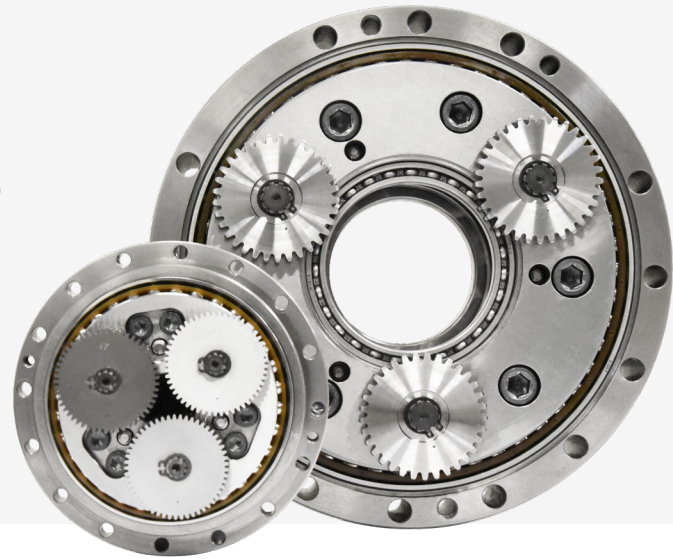

Features

High Accuracy

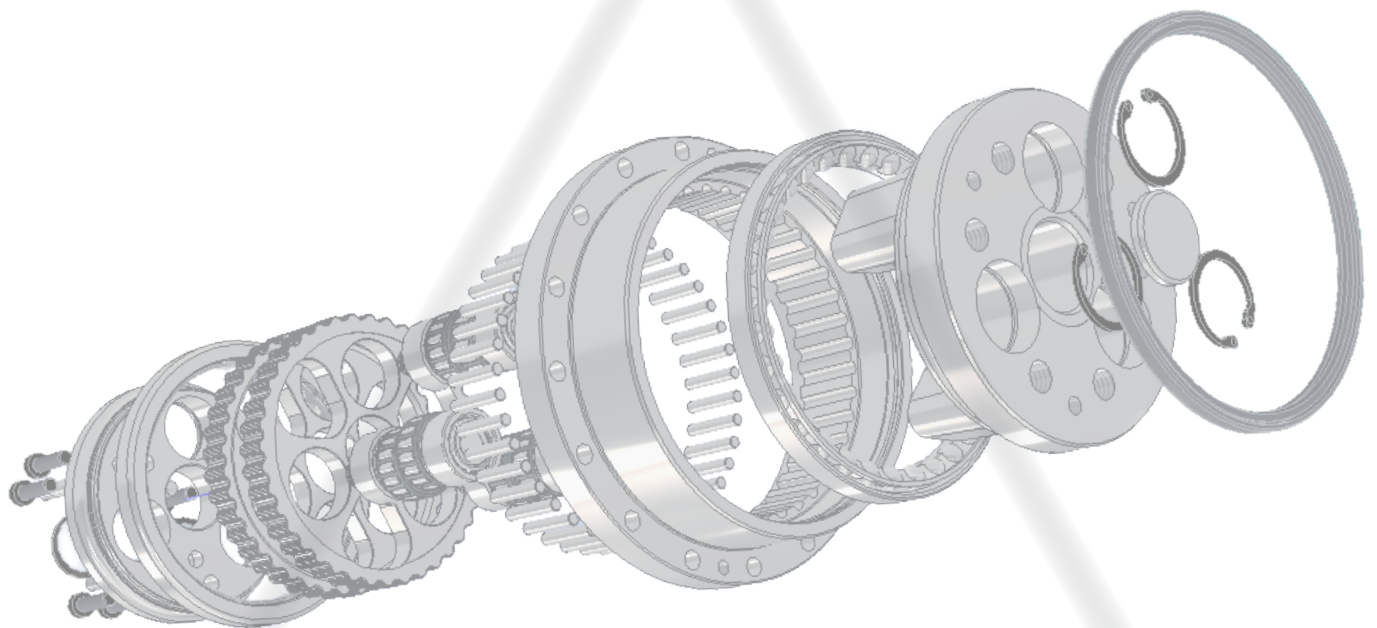

High Rigidity

Low Noise

Application

We are able to provide the most suitable specification for a variety of applications!



Articulated Robot



SCARA Robot

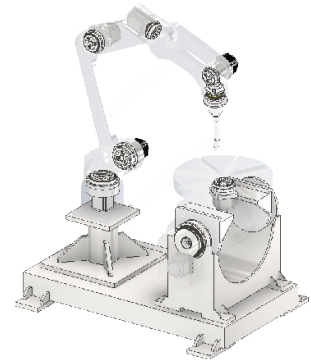

Positioner



Wafer-transfer Robot

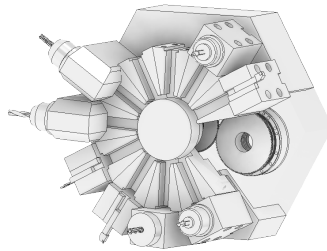

Lathe Turret Head

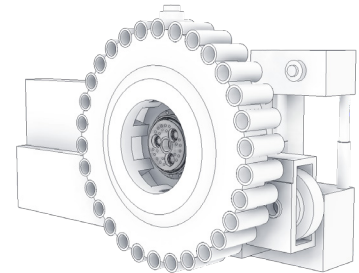

Automatic Tool Changer

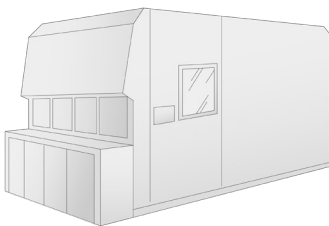

Semiconductor manufacturing equipment



Index Table

Reducer Model Nomenclature

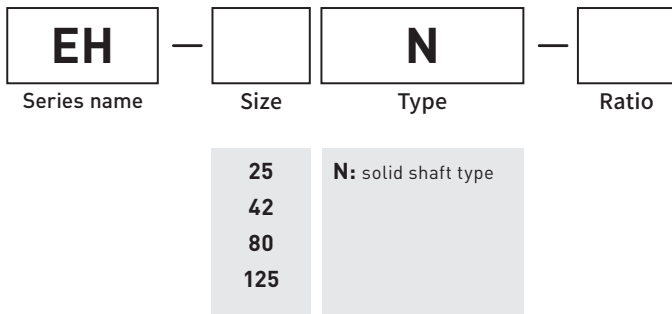

Specifications

Product Model	Ratio		※ 1				※ 2					
	Output flange rotation	Frame Rotation	Rated torque (Nm)	Rated output Speed (rpm)	Rated service life (h)	Allowable acceleration/ deceleration torque (Nm)	Nominal allowable torque (Nm)	Blash/ Lost motion (arc min)	Transmission Angular Accuracy (arc sec)	Allowable moment (Nm)	Momentary allowable moment(Max.) (Nm)	Mass (kg)
EH-25N	41	40	245	15	6,000	612	1,225	1.0/1.0	70	784	1,568	3.8
	81	80										
	107.67	106.67										
	126	125										
	137	136										
	164.07	163.07										
EH-42N	41	40	412	15	6,000	1,029	2,058	1.0/1.0	60	1,660	3,320	6.3
	81	80										
	105	104										
	126	125										
	141	140										
	164.08	163.08										
EH-80N	41	40	784	15	6,000	1,960	3,920	1.0/1.0	50	2,150	4,300	9.8
	81	80										
	101	100										
	129	128										
	141	140										
	171	170										
EH-125N	41	40	1,225	15	6,000	3,062	6,125	1.0/1.0	50	3,430	6,860	15
	81	80										
	102.18	101.18										
	121	120										
	145.62	144.62										
	161	160										

- No-load running torque will increase when the reducer is used at low temperature. Please be careful when selecting a motor.
- If you require a reduction ratio other than the above, or if you have any questions regarding motor selection, please contact our sales representative.
- The above specifications are based on our evaluation method. The customer is requested to use the product only after confirming that there are no problems under the operating conditions of the actual equipment to be installed.
 - ※ 1. The rated torque is the torque value that corresponds to the rated lifetime when operating at the rated output rotation speed, and does not indicate the upper limit of the load.
 - ※ 2. The allowable moment changes depending on the axial load.

Direction of Rotation and Reduction Ratio

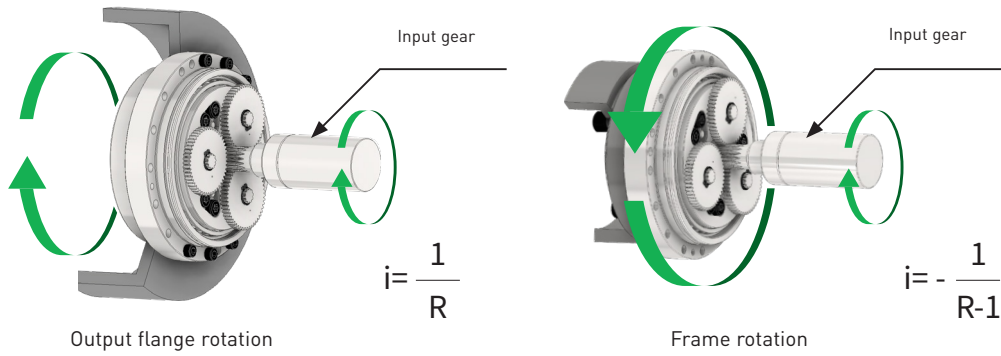

※ Input gear should be prepared on the customer side.

Mechanism Diagram

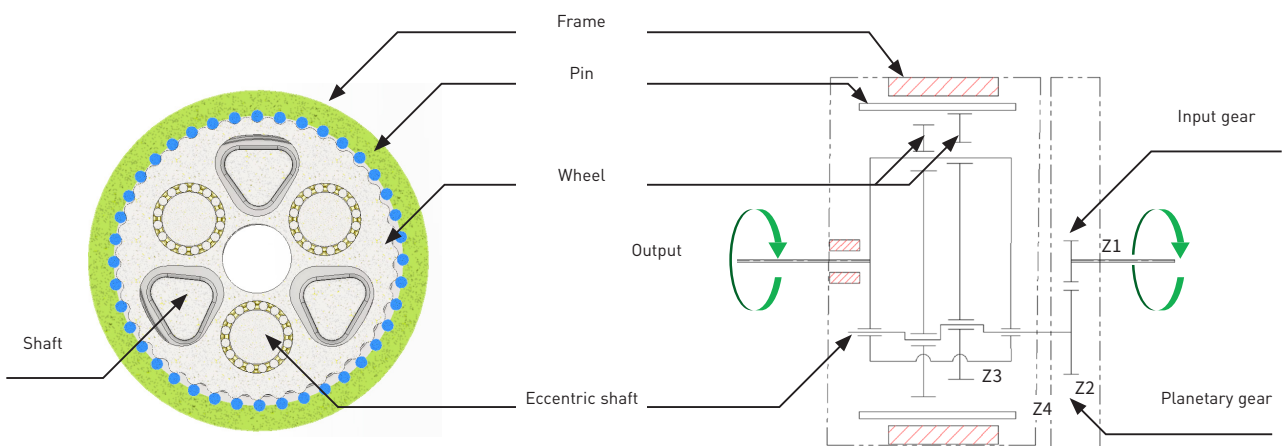

Dimensional Drawing

EH-25N

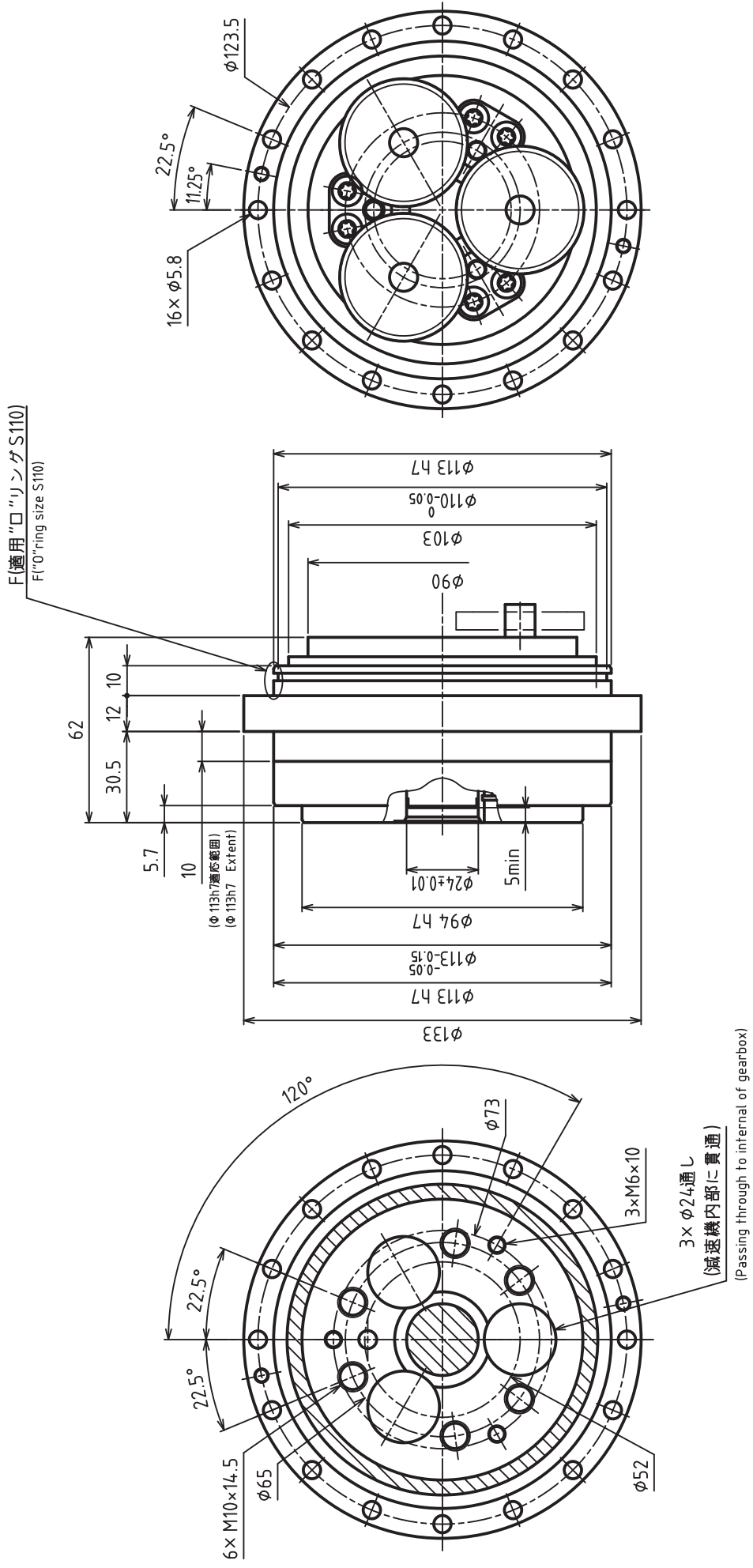

Dimensional Drawing

EH-42N

F[適合]“ロ”リング AS(ARP)568-159
F[O]ring size As(ARP)568-159

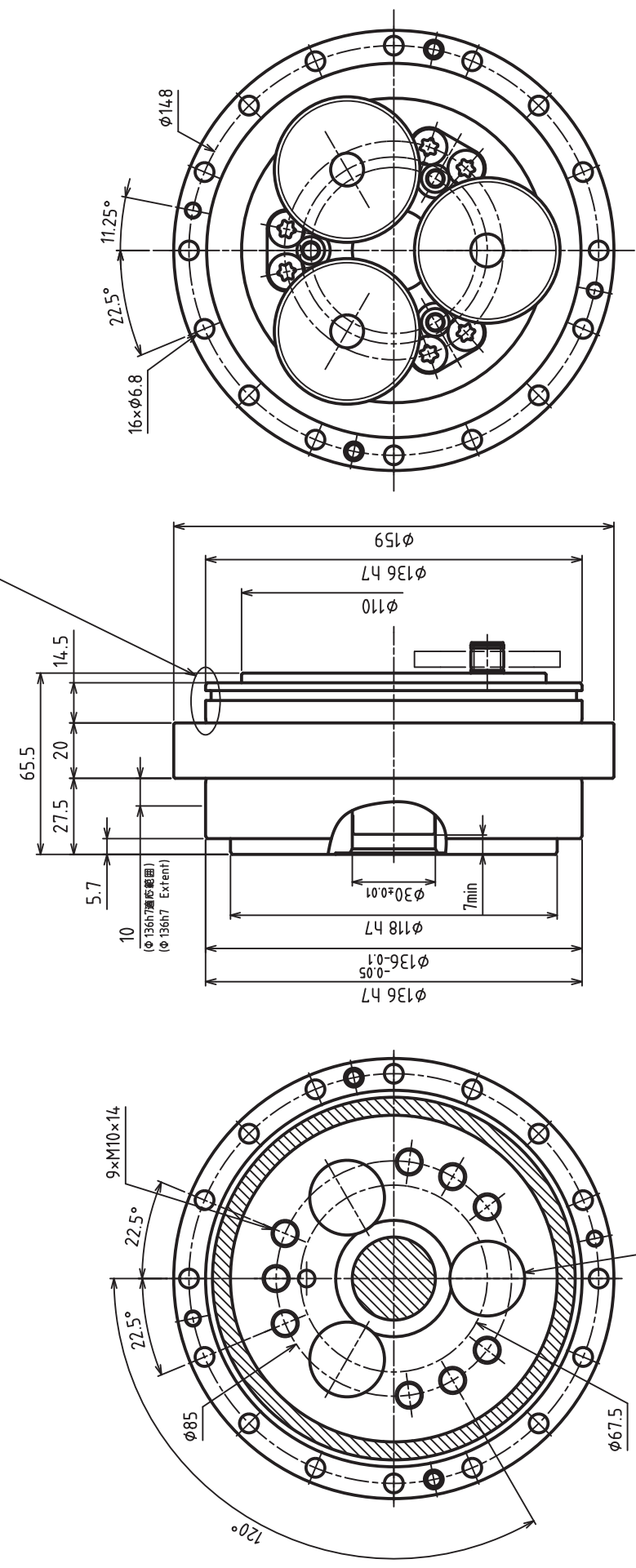

Dimensional Drawing

EH-80N

F(適応)“ロ”リングAS(ARP)568-258

F("O")ring size As(ARP)568-258)

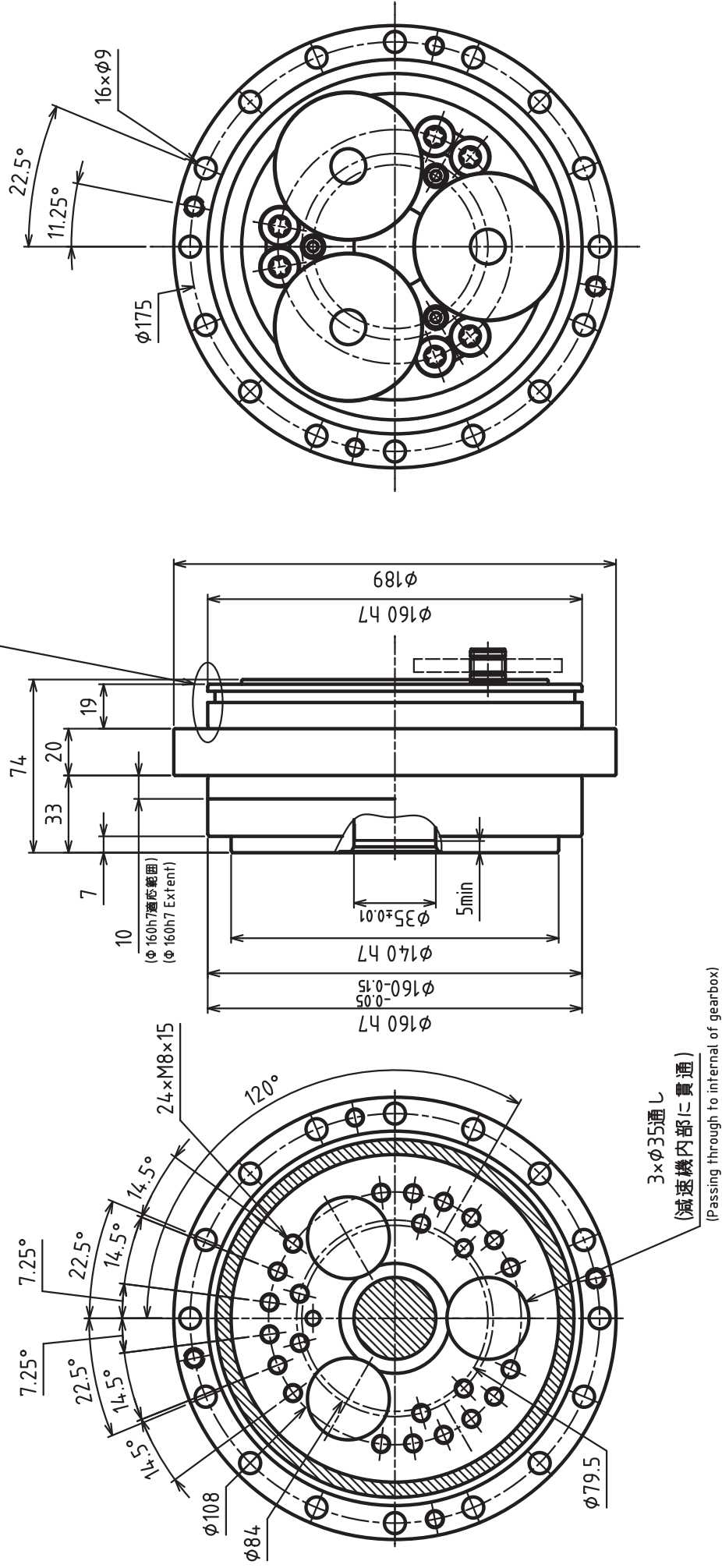

Dimensional Drawing

EH-125N

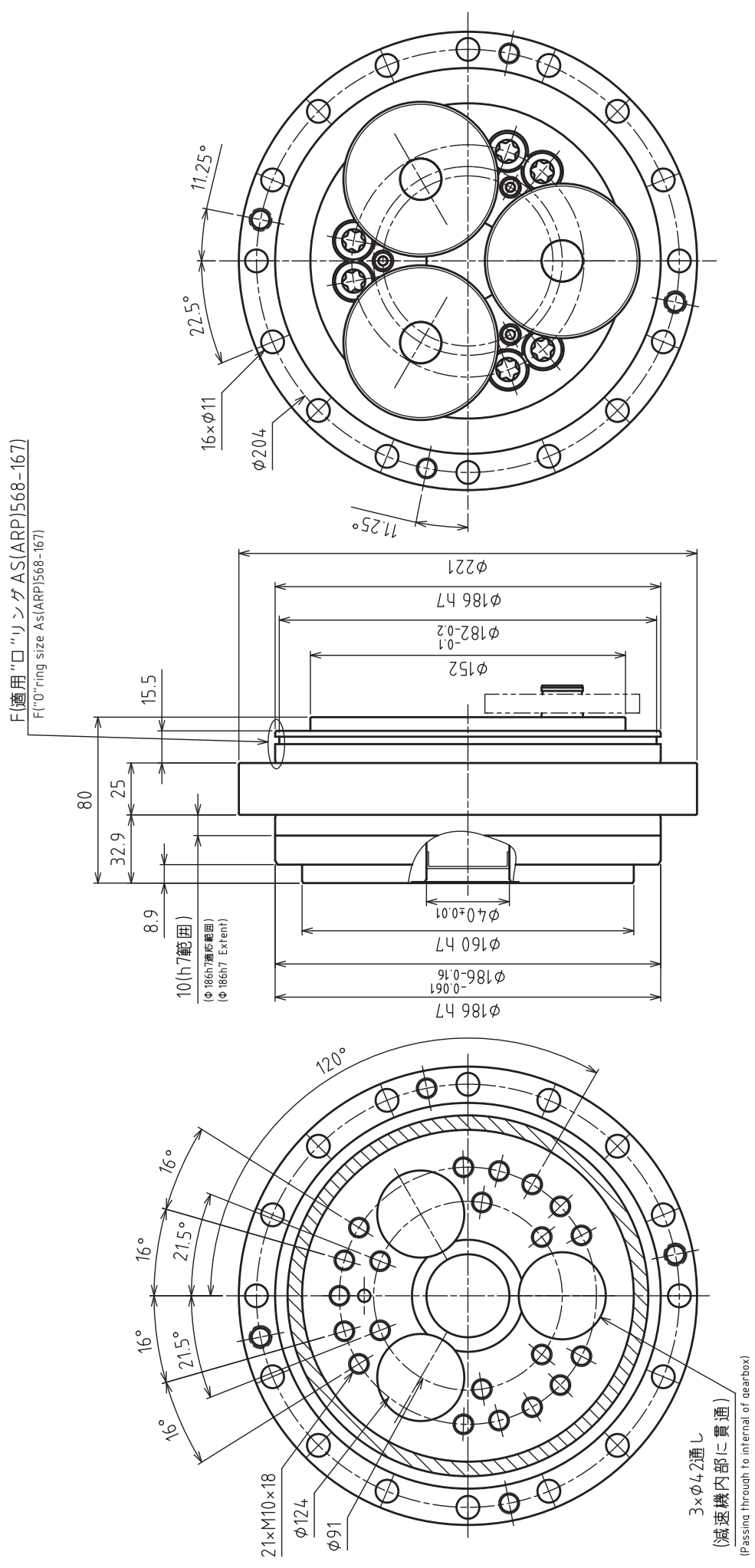

Hollow Shaft Type C Reducer Model Nomenclature

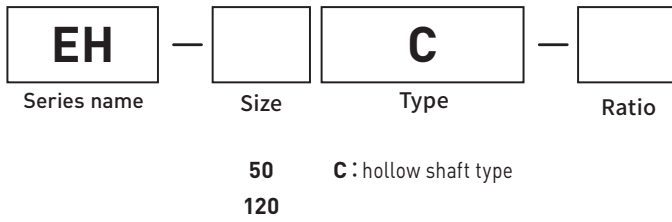

Specifications

Product Model	Ratio		※ 1				※ 2					
	Output flange rotation	Frame Rotation	Rated torque (Nm)	Rated output Speed (rpm)	Rated service life (h)	Allowable acceleration/ deceleration torque (Nm)	Nominal allowable torque (Nm)	Blash/ Lost motion (arc min)	Transmission Angular Accuracy (arc sec)	Allowable moment (Nm)	Momentary allowable moment(Max.) (Nm)	Mass (kg)
EH-50C	32.54	31.54	490	15	6,000	1,225	[Bolt] 2,450	1.0/1.0	60	1,764	3,528	16.4
EH-120C	36.75	35.75	1,177	15	6,000	2,940	5,880	1.0/1.0	50	3,920	7,350	21.2

- No-load running torque will increase when the reducer is used at low temperature. Please be careful when selecting a motor.
- If you require a reduction ratio other than the above, or if you have any questions regarding motor selection, please contact our sales representative.
- The above specifications are based on our evaluation method. The customer is requested to use the product only after confirming that there are no problems under the operating conditions of the actual equipment to be installed.

※ 1. The rated torque is the torque value that corresponds to the rated lifetime when operating at the rated output rotation speed, and does not indicate the upper limit of the load.

※ 2. The allowable moment changes depending on the axial load.

Direction of Rotation and Reduction Ratio

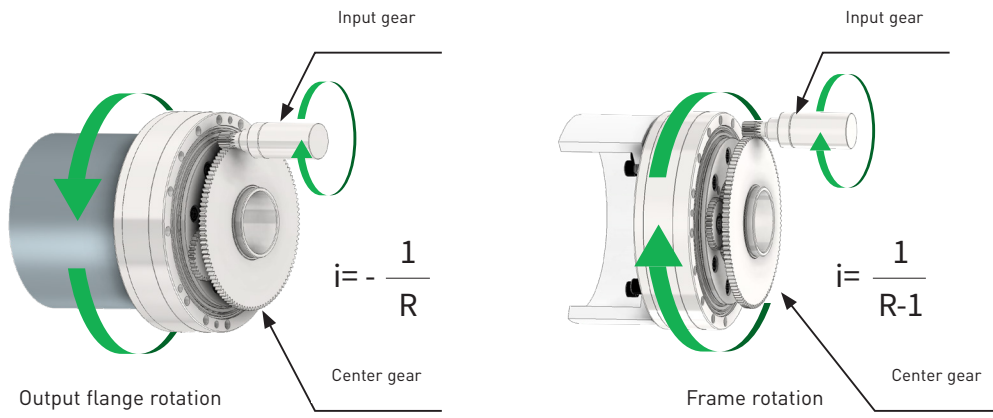

※ Input gear and center gear should be prepared on the customer side.

Mechanism Diagram

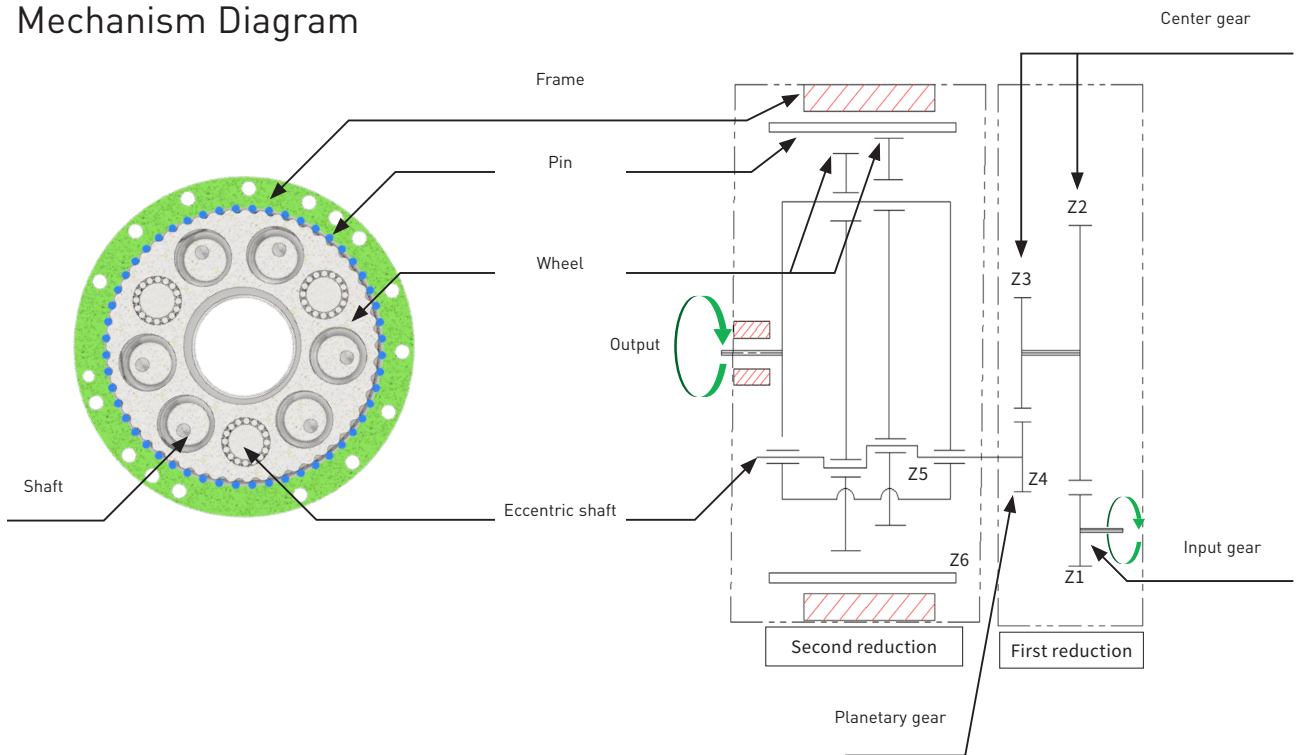

Dimensional Drawing

EH-120C

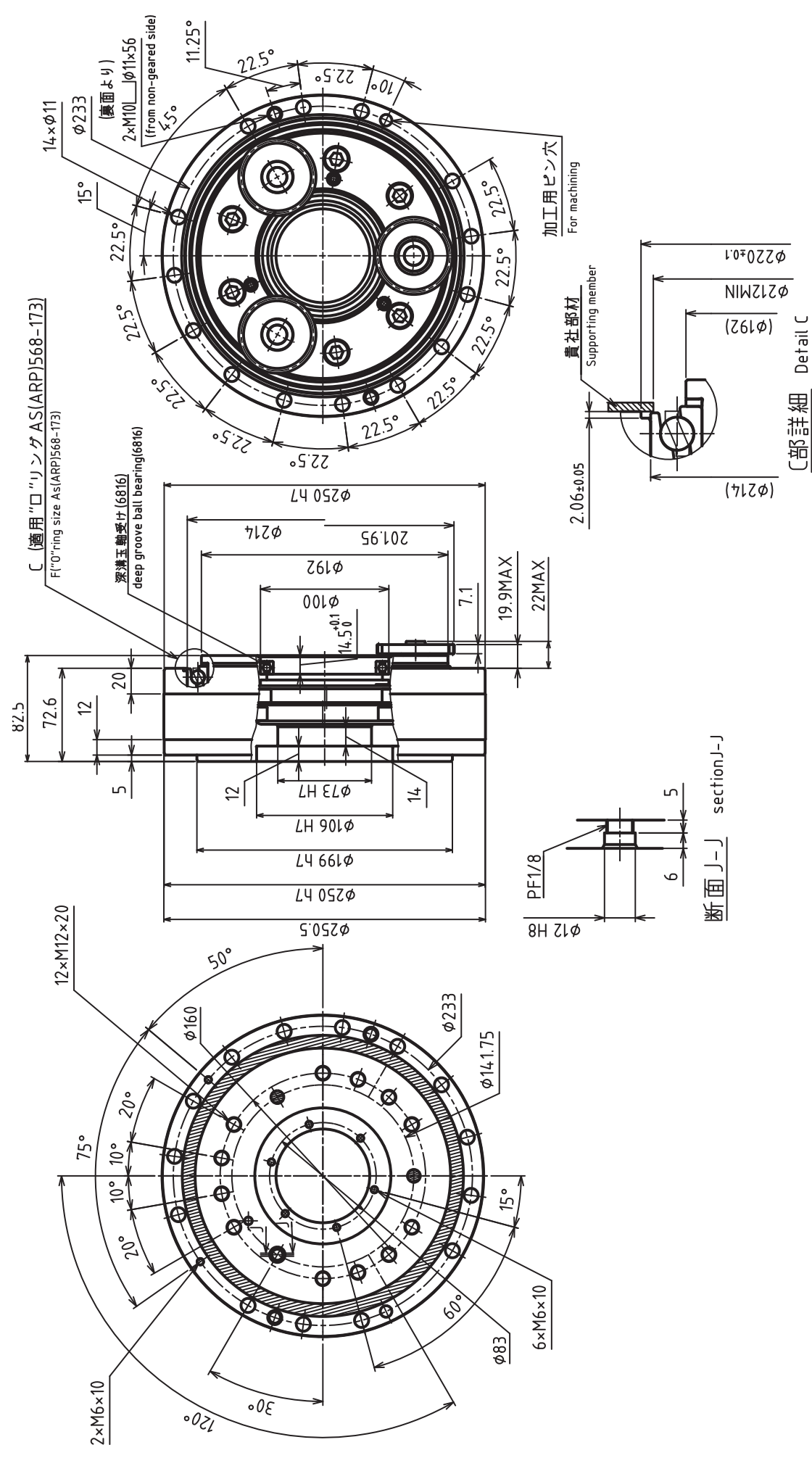

Nidec DESCH Global Services GmbH



Nidec DESCH Global Services GmbH
Kleinbahnstraße 21
59759 Arnsberg
Germany

Tel.: +49 (0) 2932 300 0
Fax: +49 (0) 2932 300 899
info@desch.com
www.desch.com